

12/19/2023 8:29 AM

# ARCADIA INC.

## SERIES IP-2550 ALUMINUM WINDOW WALL SYSTEM (WZ3) (IMPACT)



2301 EAST VERNON AVE.  
VERNON, CA 90058  
PH: (323) 771-9819

### INSTALLATION NOTES:

- ONE (1) INSTALLATION ANCHOR IS REQUIRED AT EACH ANCHOR LOCATION SHOWN.
- THE NUMBER OF INSTALLATION ANCHORS DEPICTED IS THE MINIMUM NUMBER OF ANCHORS TO BE USED FOR PRODUCT INSTALLATION.
- INSTALL INDIVIDUAL INSTALLATION ANCHORS WITHIN A TOLERANCE OF ±1/2 INCH OF THE DEPICTED LOCATION IN THE ANCHOR LAYOUT DETAIL (I.E., WITHOUT CONSIDERATION OF TOLERANCES). TOLERANCES ARE NOT CUMULATIVE FROM ONE INSTALLATION ANCHOR TO THE NEXT.
- SHIM AS REQUIRED AT EACH INSTALLATION ANCHOR WITH LOAD BEARING SHIM(S). MAXIMUM ALLOWABLE SHIM STACK TO BE 3/8 INCH. SHIM WHERE SPACE OF 1/16 INCH OR GREATER OCCURS. SHIM(S) SHALL BE CONSTRUCTED OF HIGH DENSITY PLASTIC OR BETTER.
- FOR INSTALLATION INTO WOOD FRAMING USE 5/16" LAG SCREWS OF SUFFICIENT LENGTH TO ACHIEVE 1-1/2 INCH MINIMUM EMBEDMENT INTO WOOD SUBSTRATE.
- FOR INSTALLATION THROUGH 1X BUCK TO CONCRETE/MASONRY, OR DIRECTLY INTO CONCRETE/MASONRY, USE 3/8" DEWALT SCREW-BOLT+ OF SUFFICIENT LENGTH TO ACHIEVE 2-1/2 INCH MINIMUM EMBEDMENT.
- FOR INSTALLATION THROUGH METAL STUD USE 3/8" SELF-DRILLING SCREWS, GR. 5 OF SUFFICIENT LENGTH TO ACHIEVE 3 THREADS MINIMUM PENETRATION BEYOND METAL FRAME SUBSTRATE.
- MINIMUM EMBEDMENT AND EDGE DISTANCE EXCLUDE WALL FINISHES, INCLUDING BUT NOT LIMITED TO STUCCO, FOAM, BRICK VENEER, AND SIDING.
- INSTALLATION ANCHORS AND ASSOCIATED HARDWARE MUST BE MADE OF CORROSION RESISTANT MATERIAL OR HAVE A CORROSION RESISTANT COATING.
- FOR HOLLOW BLOCK AND GROUT FILLED BLOCK, DO NOT INSTALL INSTALLATION ANCHORS INTO MORTAR JOINTS. EDGE DISTANCE IS MEASURED FROM FREE EDGE OF BLOCK OR EDGE OF MORTAR JOINT INTO FACE SHELL OF BLOCK.
- INSTALLATION ANCHORS SHALL BE INSTALLED IN ACCORDANCE WITH ANCHOR MANUFACTURER'S INSTALLATION INSTRUCTIONS, AND ANCHORS SHALL NOT BE USED IN SUBSTRATES WITH STRENGTHS LESS THAN THE MINIMUM STRENGTH SPECIFIED BY THE ANCHOR MANUFACTURER.
- INSTALLATION ANCHOR CAPACITIES FOR PRODUCTS HEREIN ARE BASED ON SUBSTRATE MATERIALS WITH THE FOLLOWING PROPERTIES:
  - WOOD - MINIMUM SPECIFIC GRAVITY OF 0.55.
  - CONCRETE -MINIMUM COMPRESSIVE STRENGTH OF 3000 PSI.
  - MASONRY - UNIT STRENGTH CONFORMS TO ASTM C-90 WITH MINIMUM COMPRESSIVE STRENGTH OF 2000 PSI.
  - STEEL - MINIMUM YIELD STRENGTH OF 33 KSI. MINIMUM 12 GA. WALL THICKNESS.
  - ALUMINUM - MINIMUM 1/8 INCH THICK, 6063-T5 ALUMINUM.

### GENERAL NOTES:

- THE PRODUCT SHOWN HEREIN IS DESIGNED AND MANUFACTURED TO COMPLY WITH THE CURRENT FLORIDA BUILDING CODE (FBC), **EXCLUDING** HVHZ AND HAS BEEN EVALUATED ACCORDING TO THE FOLLOWING:
  - ASTM E1886-19
  - ASTM E1996-20
  - ASTM E283-19
  - ASTM E330-14
  - ASTM E331-00(16)
  - AAMA 501-15
- ADEQUACY OF THE EXISTING STRUCTURAL CONCRETE/MASONRY, 2X FRAMING AND METAL STUD FRAMING AS A MAIN WIND FORCE RESISTING SYSTEM CAPABLE OF WITHSTANDING AND TRANSFERRING APPLIED PRODUCT LOADS TO THE FOUNDATION IS THE RESPONSIBILITY OF THE ENGINEER OR ARCHITECT OF RECORD FOR THE PROJECT OF INSTALLATION.
- 1X AND 2X BUCKS (WHEN USED) SHALL BE DESIGNED AND ANCHORED TO PROPERLY TRANSFER ALL LOADS TO THE STRUCTURE. BUCK DESIGN AND INSTALLATION IS THE RESPONSIBILITY OF THE ENGINEER OR ARCHITECT OF RECORD FOR THE PROJECT OF INSTALLATION.
- THE INSTALLATION DETAILS DESCRIBED HEREIN ARE GENERIC AND MAY NOT REFLECT ACTUAL CONDITIONS FOR A SPECIFIC SITE. IF SITE CONDITIONS CAUSE INSTALLATION TO DEVIATE FROM THE REQUIREMENTS DETAILED HEREIN, A LICENSED ENGINEER OR ARCHITECT SHALL PREPARE SITE SPECIFIC DOCUMENTS FOR USE WITH THIS DOCUMENT.
- APPROVED IMPACT PROTECTIVE SYSTEM **IS NOT REQUIRED** ON THIS PRODUCT IN AREAS REQUIRING IMPACT RESISTANCE IN WIND ZONE 3 OR LESS.
- APPROVED IMPACT PROTECTIVE SYSTEM **IS REQUIRED** ON THIS PRODUCT IN AREAS REQUIRING IMPACT RESISTANCE IN WIND ZONE 4.
- FRAME MATERIAL: ALUMINUM 6063-T6
- DISSIMILAR METALS INCLUDING FASTENERS THAT MAY COME INTO CONTACT WITH ALUMINUM UNIT FRAMING SHALL BE PROTECTED IN ACCORDANCE WITH THE CURRENT FBC.
- GLASS MEETS THE REQUIREMENTS OF ASTM E 1300 GLASS CHARTS. SEE SHEET 3 FOR GLAZING DETAILS.

TABLE OF CONTENTS	
SHEET	SHEET DESCRIPTION
1	INSTALLATION & GENERAL NOTES
2	ELEVATION & ANCHOR LAYOUT
3	GLAZING DETAILS AND GLASS CAPACITY TABLES
4	MULLION CAPACITY TABLES
5	ANCHOR TYPES A, B, & C CAPACITY TABLES
6	VERTICAL SECTIONS
7	HORIZONTAL SECTIONS
8	BILL OF MATERIALS AND COMPONENTS

### INSTRUCTIONS FOR USE:

- DETERMINE DESIGN WIND LOAD REQUIREMENTS BASED ON WIND VELOCITY, BUILDING HEIGHT, RISK CATEGORY, & WIND ZONE USING APPLICABLE ASCE 7 STANDARD.
- SEE CHARTS ON SHEET 3 FOR DESIGN LOAD CAPACITY OF DESIRED GLASS SIZE.
- CHECK MULLION CAPACITY FOR A GIVEN SPACING AND HEIGHT USING CHARTS ON SHEETS 4.
- USING CHART ON SHEET 5 SELECT ANCHOR OPTION WITH DESIGN RATING MORE THAN DESIGN LOAD SPECIFIED IN STEP 1 ABOVE.
- THE LOWEST VALUE RESULTING FROM STEP 2, 3 AND 4 SHALL APPLY TO ENTIRE SYSTEM.

TITLE: SERIES IP-2550 ALUMINUM WINDOW WALL SYSTEM (WZ3) (IMPACT)

INSTALLATION & GENERAL NOTES

PREPARED BY: BUILDING DROPS, INC.  
1900 NE MIAMI COURT, STE. 2-15  
MIAMI, FL 33132  
PH: (954) 399-8478  
FAX: (954) 744-4738  
WEB: www.buildingdrops.com

REMARKS	BY	DATE

THE INSTALLATION DETAILS DESCRIBED HEREIN ARE GENERIC AND MAY NOT REFLECT ACTUAL CONDITIONS FOR A SPECIFIC SITE. IF SITE CONDITIONS CAUSE INSTALLATION TO DEVIATE FROM THE REQUIREMENTS DETAILED HEREIN, A LICENSED ENGINEER OR ARCHITECT SHALL PREPARE SITE SPECIFIC DOCUMENTS FOR USE WITH THIS DOCUMENT.

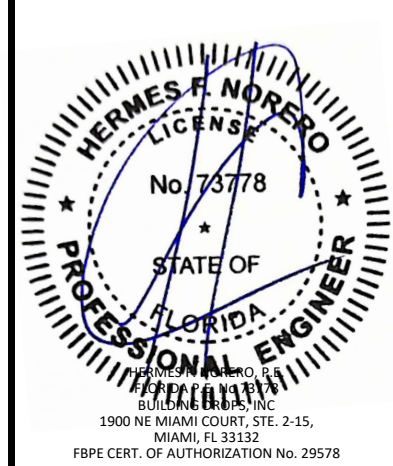

FL #: **FL45921**

DATE: **11.30.2023**

DWG. BY: <b>SH</b>	CHK. BY: <b>HN</b>
--------------------	--------------------

SCALE: **NTS**

DWG. #: **ARC013**

SHEET: **1** OF **8**

s:\projects\arcadia\_incl\arc-23-0917.3 - fbc submittal - ip2550 & ip2551 window wall system.dwg\arc013 - fbc\_23.dwg

12/19/2023 8:29 AM  
s:\projects\arcadia, inc\lbc-23-0917.3 - fbc submittal - ip2550 & ip2551 window wall system\dwgs\arc013 - fbc 23.dwg

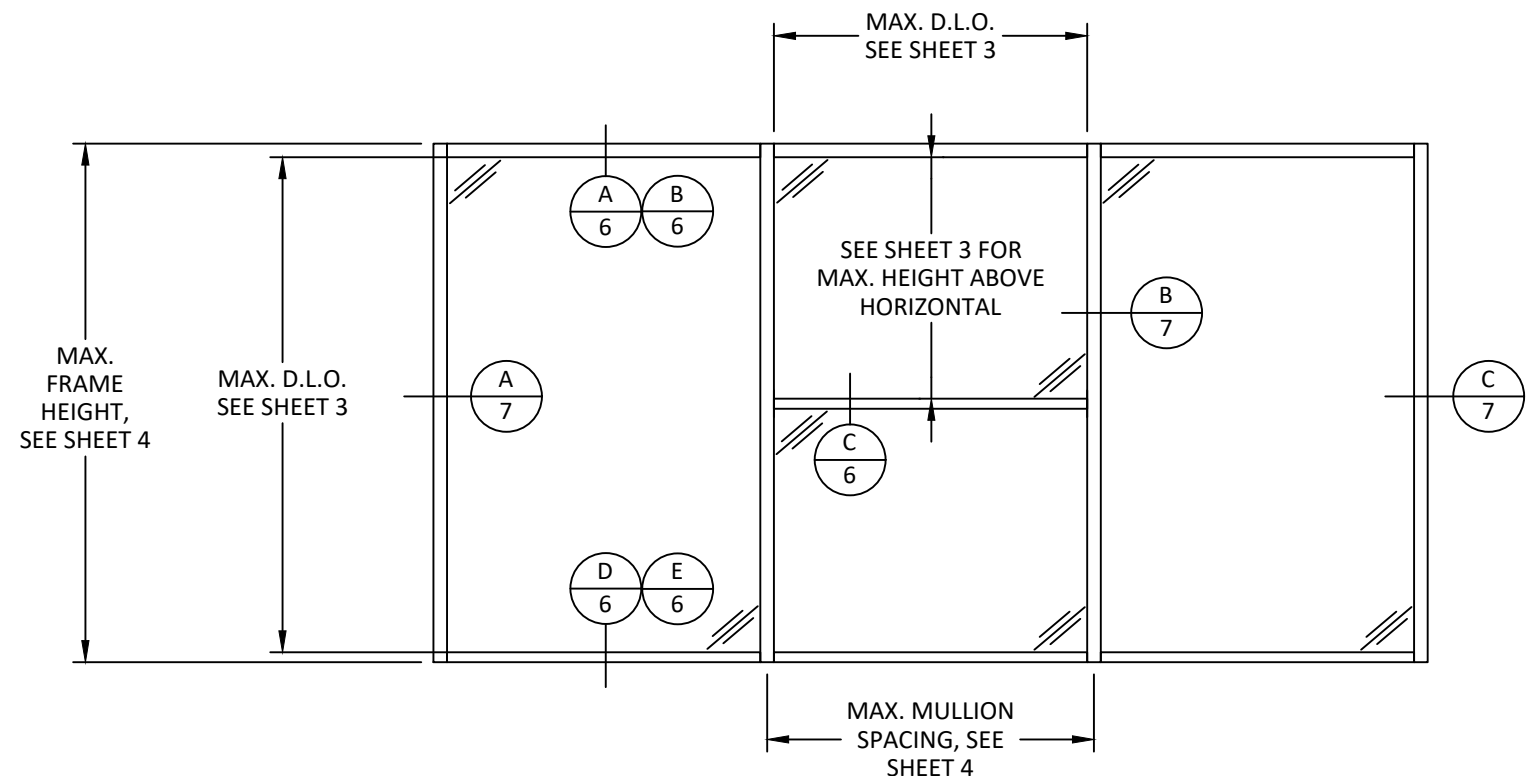

**ELEVATION**

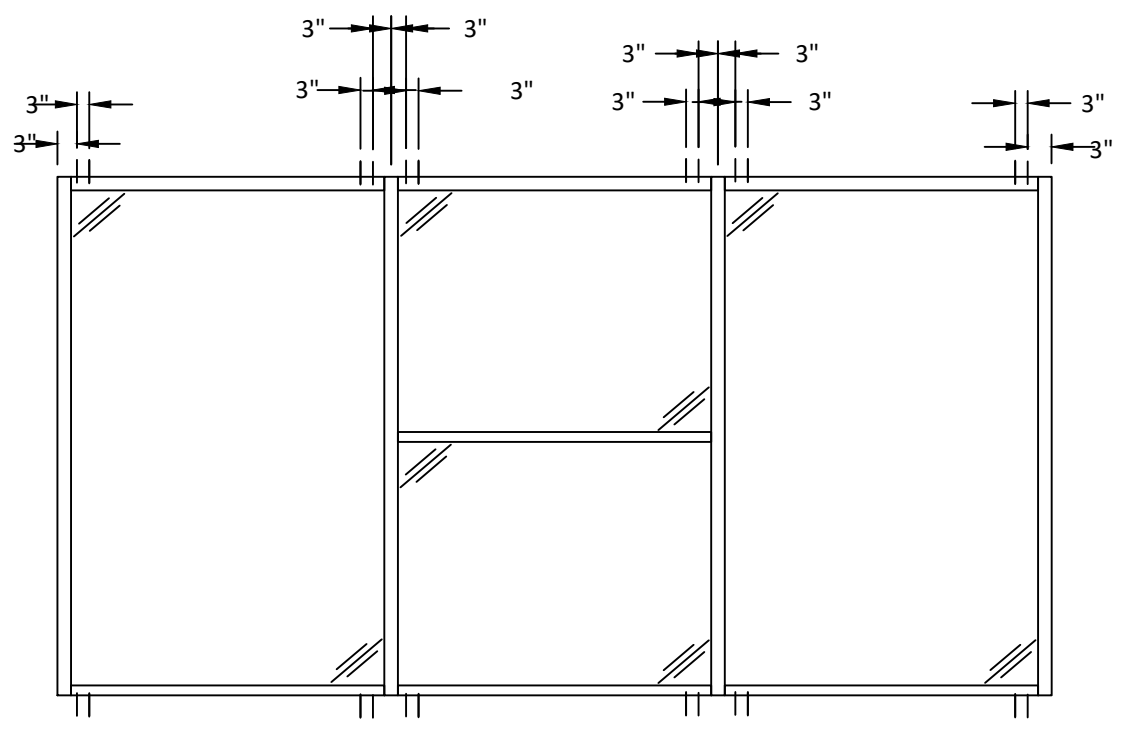

NOTE:  
SEE SHEET 6 FOR CORRESPONDING ANCHOR TYPES AND CAPACITIES.

**ANCHOR LAYOUT**



2301 EAST VERNON AVE.  
VERNON, CA 90058  
PH: (323) 771-9819

TITLE: SERIES IP-2550 ALUMINUM WINDOW WALL SYSTEM (WZ3) (IMPACT)  
ELEVATION & ANCHOR LAYOUT

PREPARED BY:  
**BUILDING DROPS, INC.**  
1900 NE MIAMI COURT, STE. 2-15  
MIAMI, FL 33132  
PH: (954) 399-8478  
FAX: (954) 474-4738  
WEB: www.buildingdrops.com



REMARKS	BY	DATE

THE INSTALLATION DETAILS DESCRIBED HEREIN ARE GENERIC AND MAY NOT REFLECT ACTUAL CONDITIONS FOR A SPECIFIC SITE. IF SITE CONDITIONS CAUSE INSTALLATION TO DEVIATE FROM THE REQUIREMENTS DETAILED HEREIN, A LICENSED ENGINEER OR ARCHITECT SHALL PREPARE SITE SPECIFIC DOCUMENTS FOR USE WITH THIS DOCUMENT.

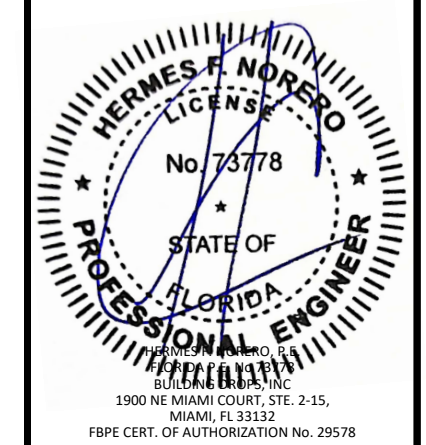

FL #:	<b>FL45921</b>
DATE:	<b>11.30.2023</b>
DWG. BY:	<b>SH</b>
CHK. BY:	<b>HN</b>
SCALE:	<b>NTS</b>
DWG. #:	<b>ARC013</b>

SHEET:  
**2**  
OF 8





# MULLION CAPACITY TABLES

DESIGN LOAD CAPACITY - PSF						
NOMINAL DIMS.		JAMB - J1		MULLION - M1		
WIDTH (W)	FRAME HEIGHT	EXT. (+)	INT. (-)	EXT. (+)	INT. (-)	
30	60	70.0	70.0	70.0	70.0	
36		70.0	70.0	70.0	70.0	
42		70.0	70.0	70.0	70.0	
48		70.0	70.0	70.0	70.0	
54		70.0	70.0	70.0	70.0	
60		70.0	70.0	70.0	70.0	
66		70.0	70.0	70.0	70.0	
72		66.7	70.0	66.7	70.0	
78		61.5	70.0	61.5	70.0	
30		66	70.0	70.0	70.0	70.0
36	70.0		70.0	70.0	70.0	
42	70.0		70.0	70.0	70.0	
48	70.0		70.0	70.0	70.0	
54	70.0		70.0	70.0	70.0	
60	70.0		70.0	70.0	70.0	
66	66.1		70.0	66.1	70.0	
72	60.6		70.0	60.6	70.0	
78	55.9		67.1	55.9	67.1	
30	72		70.0	70.0	70.0	70.0
36		70.0	70.0	70.0	70.0	
42		70.0	70.0	70.0	70.0	
48		70.0	70.0	70.0	70.0	
54		70.0	70.0	70.0	70.0	
60		66.7	70.0	66.7	70.0	
66		60.6	70.0	60.6	70.0	
72		55.6	66.7	55.6	66.7	
78		51.3	61.5	51.3	61.5	
30		78	70.0	70.0	70.0	70.0
36	70.0		70.0	70.0	70.0	
42	70.0		70.0	70.0	70.0	
48	70.0		70.0	70.0	70.0	
54	68.4		70.0	68.4	70.0	
60	61.5		70.0	61.5	70.0	
66	55.9		67.1	55.9	67.1	
72	51.3		61.5	51.3	61.5	
30	84		70.0	70.0	70.0	70.0
36			70.0	70.0	70.0	70.0
42		70.0	70.0	70.0	70.0	
48		70.0	70.0	70.0	70.0	
54		63.5	70.0	63.5	70.0	
60		57.1	68.6	57.1	68.6	
66		51.9	62.3	51.9	62.3	

DESIGN LOAD CAPACITY - PSF									
NOMINAL DIMS.		JAMB - J1		MULLION - M1					
WIDTH (W)	FRAME HEIGHT	EXT. (+)	INT. (-)	EXT. (+)	INT. (-)				
30	90	70.0	70.0	70.0	70.0				
36		70.0	70.0	70.0	70.0				
42		70.0	70.0	70.0	70.0				
48		66.7	70.0	66.7	70.0				
54		59.3	70.0	59.3	70.0				
60		53.3	64.0	53.3	64.0				
30		96	70.0	70.0	70.0	70.0			
36			70.0	70.0	70.0	70.0			
42			70.0	70.0	70.0	70.0			
48			62.5	70.0	62.5	70.0			
54	55.6		66.7	55.6	66.7				
60	50.0		60.0	50.0	60.0				
30	102		70.0	70.0	70.0	70.0			
36			69.5	70.0	69.5	70.0			
42			59.6	70.0	59.6	70.0			
48			52.1	62.5	52.1	62.5			
54		46.3	55.6	46.3	55.6				
30		108	70.0	70.0	70.0	70.0			
36			58.5	70.0	58.5	70.0			
42			50.2	60.2	50.2	60.2			
48			43.9	52.7	43.9	52.7			
30			114	59.7	70.0	59.7	70.0		
36	49.8			59.7	49.8	59.7			
42	42.7			51.2	42.7	51.2			
48	37.3			44.8	37.3	44.8			
30	120			51.2	61.4	51.2	61.4		
36				42.7	51.2	42.7	51.2		
42		36.6		43.9	36.6	43.9			
30		126		44.2	53.1	44.2	53.1		
36				36.9	44.2	36.9	44.2		
42				31.6	37.9	31.6	37.9		
30			132	38.5	46.2	38.5	46.2		
36				32.1	38.5	32.1	38.5		
42				27.5	33.0	27.5	33.0		
30				138	33.7	40.4	33.7	40.4	
36	28.1				33.7	28.1	33.7		
30	144				29.6	35.6	29.6	35.6	
36					24.7	29.6	24.7	29.6	
30		150			26.2	31.5	26.2	31.5	
36					21.8	26.2	21.8	26.2	
30					156	23.3	28.0	23.3	28.0
36			19.4			23.3	19.4	23.3	
30			162			20.8	25.0	20.8	25.0

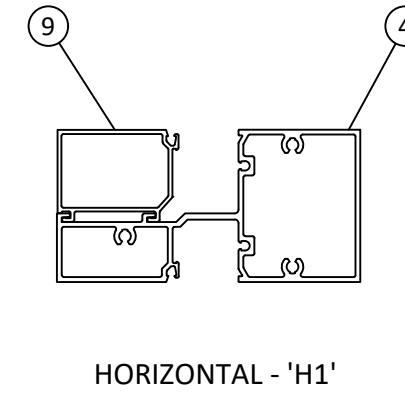
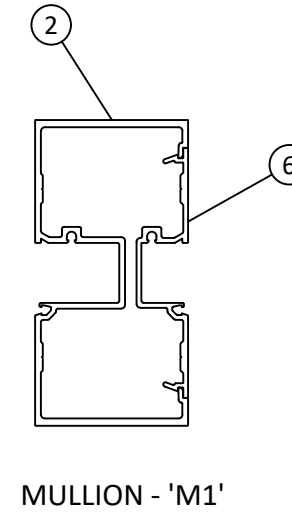
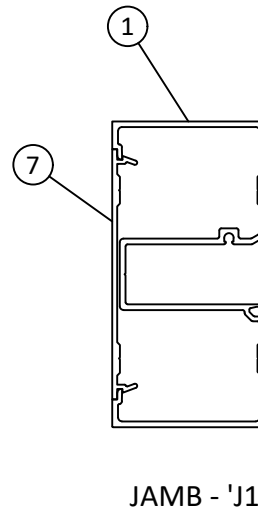

LIMIT DESIGN LOADS FOR HORIZONTAL AS FOLLOWS		
MAX HORIZ. SPAN (in.)	MAX GLASS HEIGHT ABOVE HORIZ. (in.)	MAX DESIGN LOADS (PSF)
		HORIZONTAL - H1
39.5	66	70
45.5	60	70
51.5	54	70
57.5	48	70
63.5	42	70
69.5	36	70
75.5	30	70

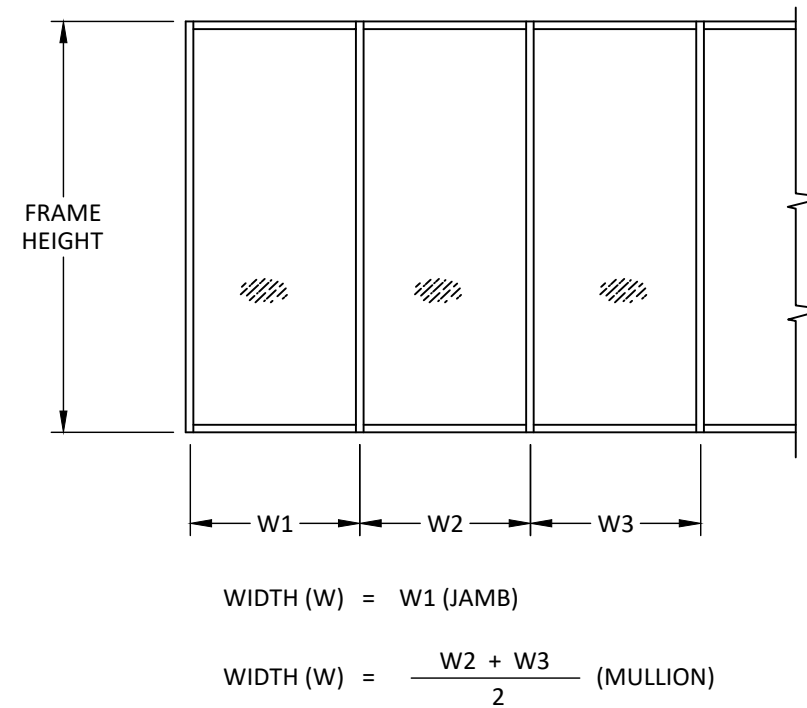

2301 EAST VERNON AVE.  
VERNON, CA 90058  
PH: (323) 771-9819

TITLE: SERIES IP-2550 ALUMINUM WINDOW WALL SYSTEM (WZ3) (IMPACT)

MULLION CAPACITY TABLES

PREPARED BY: BUILDING DROPS, INC.  
1900 NE MIAMI COURT, STE. 2-15  
MIAMI, FL 33132  
PH: (954) 399-8478  
FAX: (954) 474-4738  
WEB: www.buildingdrops.com



REMARKS	BY	DATE

THE INSTALLATION DETAILS DESCRIBED HEREIN ARE GENERIC AND MAY NOT REFLECT ACTUAL CONDITIONS FOR A SPECIFIC SITE. IF SITE CONDITIONS CAUSE INSTALLATION TO DEVIATE FROM THE REQUIREMENTS DETAILED HEREIN, A LICENSED ENGINEER OR ARCHITECT SHALL PREPARE SITE SPECIFIC DOCUMENTS FOR USE WITH THIS DOCUMENT.

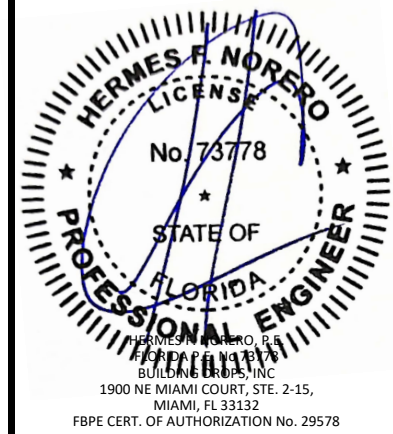

FL #: **FL45921**

DATE: **11.30.2023**

DWG. BY: **SH**      CHK. BY: **HN**

SCALE: **NTS**

DWG. #: **ARC013**

SHEET: **4** OF 8





12/19/2023 8:29 AM  
 s:\projects\arcadia, inc\lbc-23-0917.3 - lbc submittal - ip2550 & ip2551 window wall system\dwg\arc013 - lbc - 23.dwg

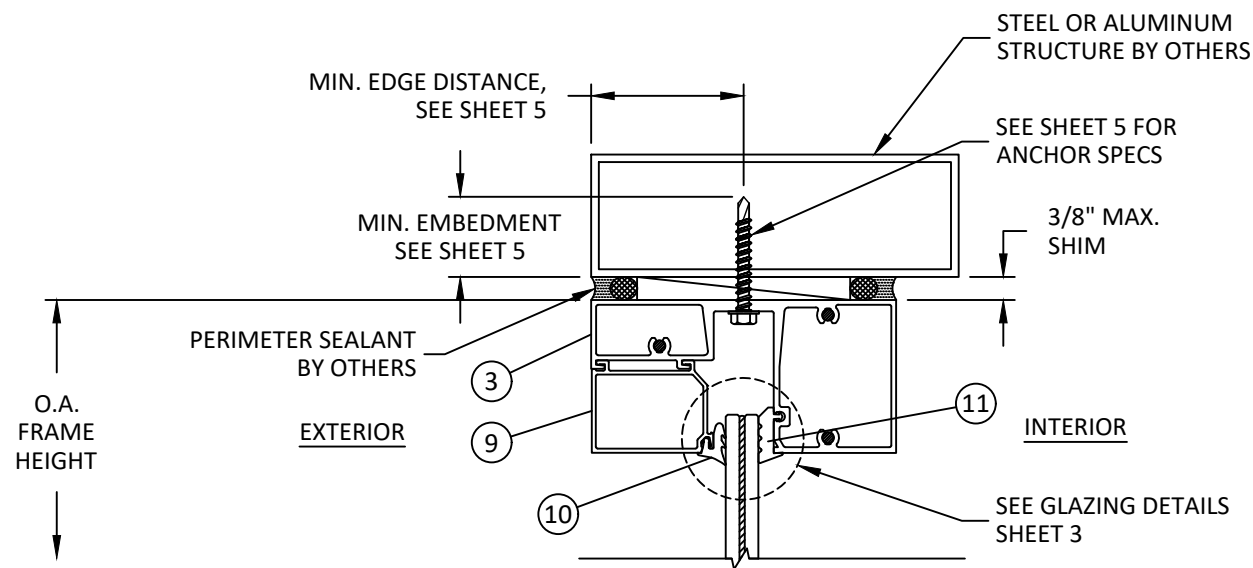

**A**  
**6** VERTICAL SECTION  
HEAD - STEEL / ALUMINUM SUBSTRATE

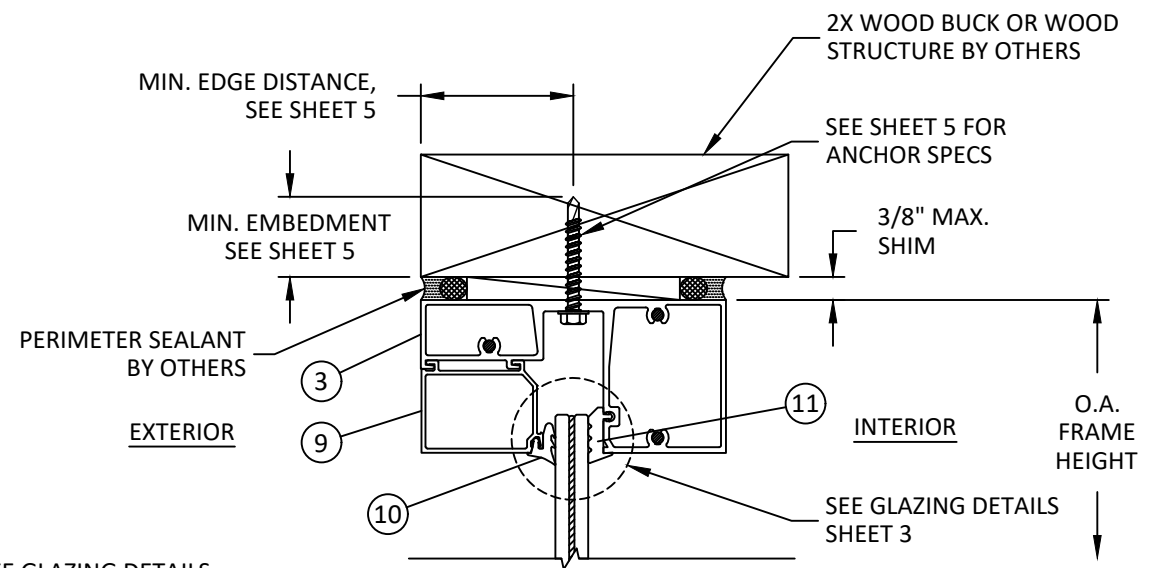

**B**  
**6** VERTICAL SECTION  
HEAD - WOOD SUBSTRATE

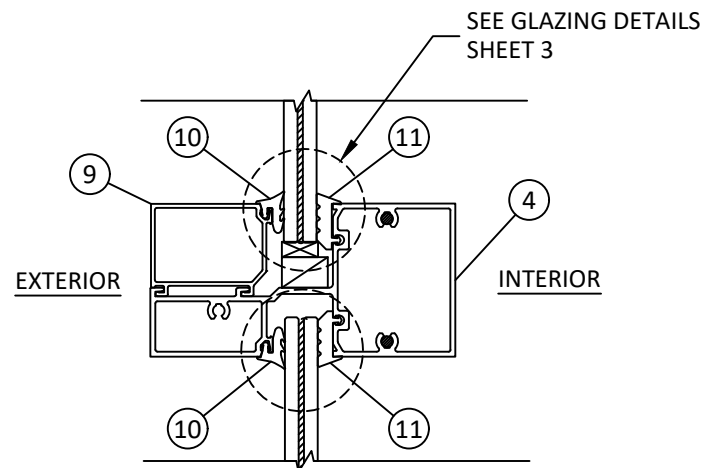

**C**  
**6** VERTICAL SECTION  
HORIZONTAL

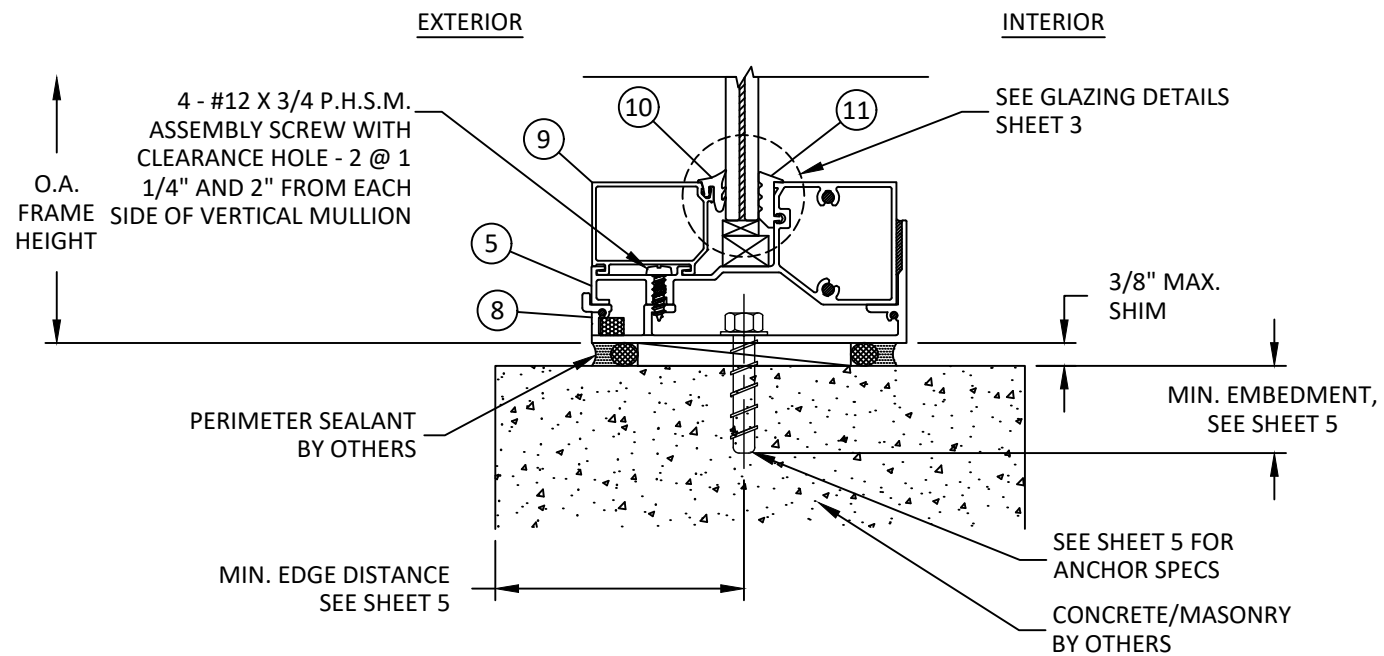

**D**  
**6** VERTICAL SECTION  
SILL - CONCRETE/MASONRY SUBSTRATE

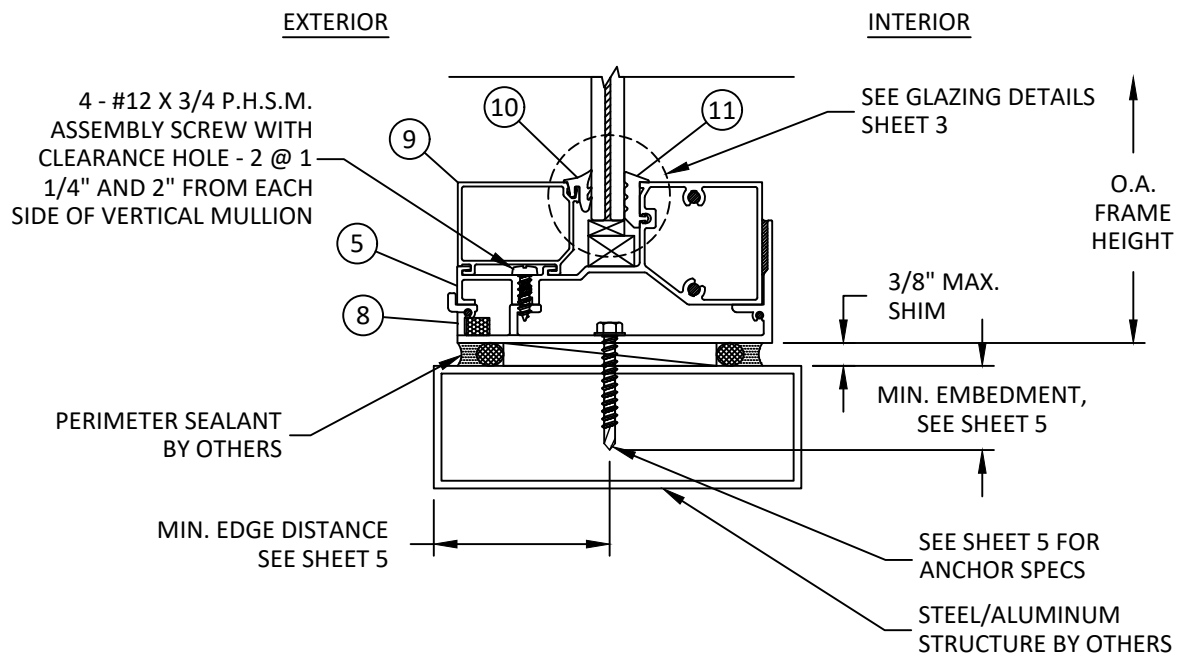

**E**  
**6** VERTICAL SECTION  
SILL - STEEL/ALUMINUM SUBSTRATE

  
 2301 EAST VERNON AVE.  
 VERNON, CA 90058  
 PH: (323) 771-9819

TITLE: SERIES IP-2550 ALUMINUM WINDOW WALL SYSTEM (WZ3) (IMPACT)  
 VERTICAL SECTIONS  
 PREPARED BY: BUILDING DROPS, INC.  
 1900 NE MIAMI COURT, STE. 2-15  
 MIAMI, FL 33132  
 PH: (954) 399-8478  
 FAX: (954) 744-4738  
 WEB: www.buildingdrops.com  

REMARKS	BY	DATE

THE INSTALLATION DETAILS DESCRIBED HEREIN ARE GENERIC AND MAY NOT REFLECT ACTUAL CONDITIONS FOR A SPECIFIC SITE. IF SITE CONDITIONS CAUSE INSTALLATION TO DEVIATE FROM THE REQUIREMENTS DETAILED HEREIN, A LICENSED ENGINEER OR ARCHITECT SHALL PREPARE SITE SPECIFIC DOCUMENTS FOR USE WITH THIS DOCUMENT.

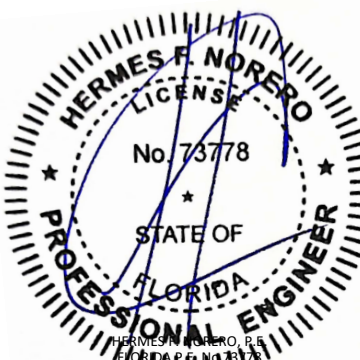
  
 HERMES F. NORERO  
 LICENSE  
 No. 73778  
 STATE OF FLORIDA  
 PROFESSIONAL ENGINEER  
 HERMES F. NORERO, P.E.  
 BUILDING DROPS, INC.  
 1900 NE MIAMI COURT, STE. 2-15,  
 MIAMI, FL 33132  
 FBPE CERT. OF AUTHORIZATION No. 29578

FL #: **FL45921**  
 DATE: **11.30.2023**  
 DWG. BY: **SH**      CHK. BY: **HN**  
 SCALE: **NTS**  
 DWG. #: **ARC013**





2301 EAST VERNON AVE.  
VERNON, CA 90058  
PH: (323) 771-9819

TITLE: SERIES IP-2550 ALUMINUM WINDOW WALL SYSTEM (WZ3) (IMPACT)

HORIZONTAL SECTIONS

PREPARED BY: BUILDING DROPS, INC.  
1900 NE MIAMI COURT, STE. 2-15  
MIAMI, FL 33132  
PH: (954) 399-8478  
FAX: (954) 474-4738  
WEB: www.buildingdrops.com

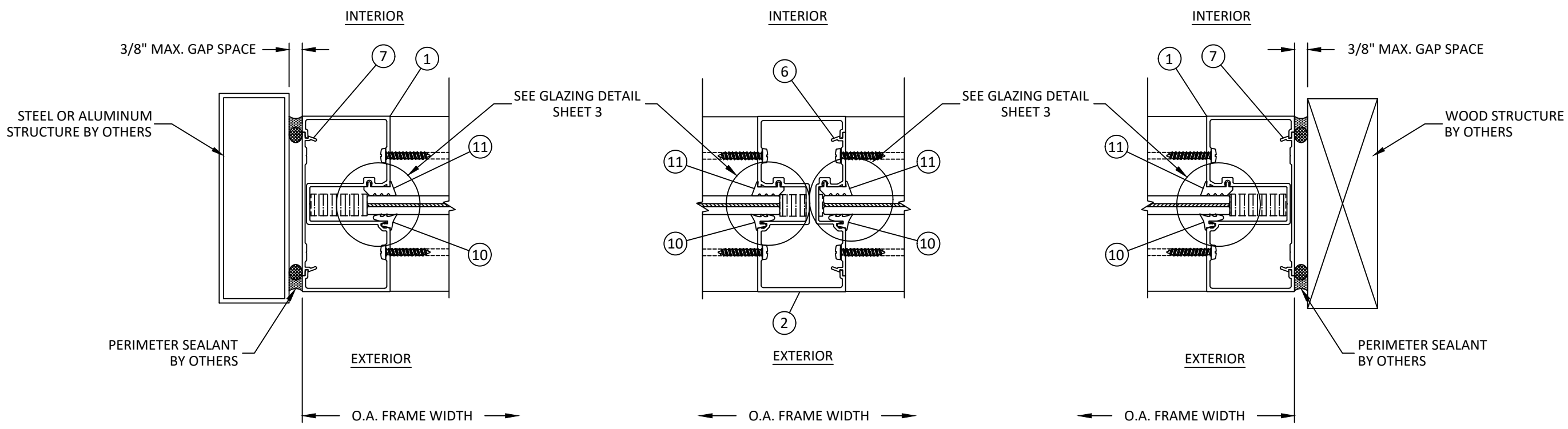

**A**  
**7** VERTICAL SECTION  
JAMB - STEEL/ALUMINUM SUBSTRATE

**B**  
**7** VERTICAL SECTION  
MULLION

**C**  
**7** VERTICAL SECTION  
JAMB - WOOD SUBSTRATE

REMARKS	BY	DATE

THE INSTALLATION DETAILS DESCRIBED HEREIN ARE GENERIC AND MAY NOT REFLECT ACTUAL CONDITIONS FOR A SPECIFIC SITE. IF SITE CONDITIONS CAUSE INSTALLATION TO DEVIATE FROM THE REQUIREMENTS DETAILED HEREIN, A LICENSED ENGINEER OR ARCHITECT SHALL PREPARE SITE SPECIFIC DOCUMENTS FOR USE WITH THIS DOCUMENT.

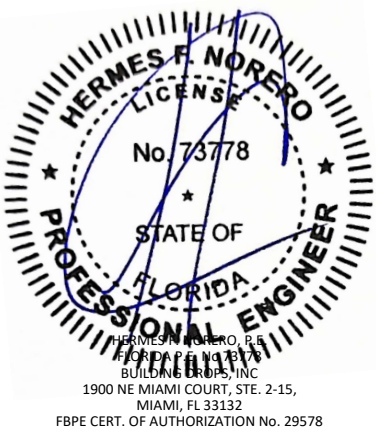

FL #:	<b>FL45921</b>
DATE:	<b>11.30.2023</b>
DWG. BY:	<b>SH</b>
CHK. BY:	<b>HN</b>
SCALE:	<b>NTS</b>
DWG. #:	<b>ARC013</b>
SHEET:	<b>7</b>

s:\projects\arcadia, inc\lrc-23-0917.3 - fbc submittal - ip2550 & ip2551 window wall system\dwg\arc013 - fbc 23.dwg

### BILL OF MATERIALS

ITEM	PART No.	DESCRIPTION	MATERIAL	MANUFACTURER
1	IP-522	JAMB	6063-T6	ARCADIA INC.
2	IP-502	VERTICAL	6063-T6	ARCADIA INC.
3	IP-523	HEAD	6063-T6	ARCADIA INC.
4	IP-513	HORIZONTAL	6063-T6	ARCADIA INC.
5	IP-553	SILL	6063-T6	ARCADIA INC.
6	IP-510	VERTICAL FILLER	6063-T6	ARCADIA INC.
7	IP-500	HEAD FILLER	6063-T6	ARCADIA INC.
8	IP-551	SILL END DAM	6063-T6	ARCADIA INC.
9	IP-513 STOP	FRAME STOP	6063-T6	ARCADIA INC.
10	TR-14090E	GLAZING GASKET	NEOPRENE	BY OTHERS
11	-	GLAZING GASKET	NEOPRENE	BY OTHERS

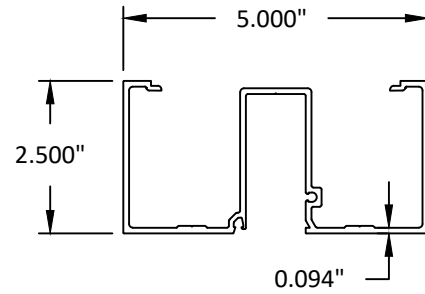

1 JAMB  
IP-522

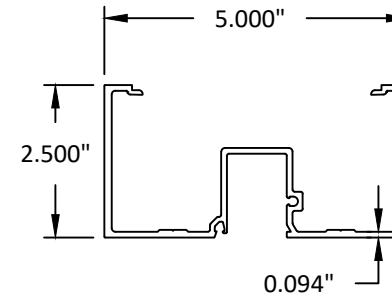

2 VERTICAL  
IP-502

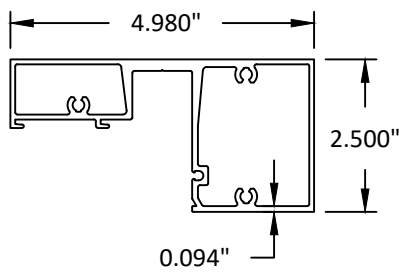

3 HEAD  
IP-523

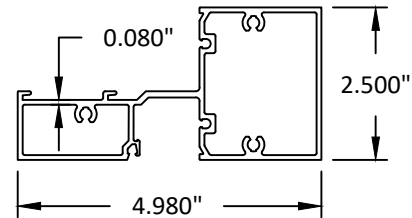

4 HORIZONTAL  
IP-513

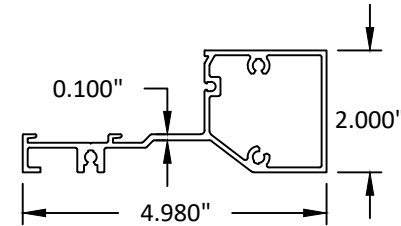

5 SILL  
IP-553

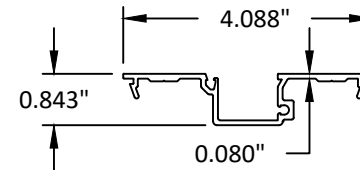

6 VERTICAL FILLER  
IP-510

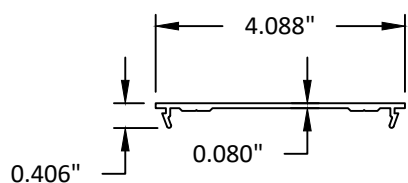

7 HEAD FILLER  
IP-500

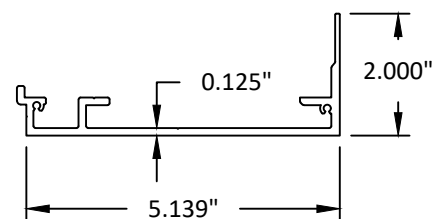

8 SILL END DAM  
IP-551

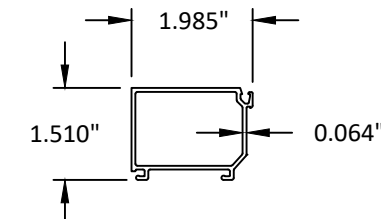

9 FRAME STOP  
IP-513 STOP



2301 EAST VERNON AVE.  
VERNON, CA 90058  
PH: (323) 771-9819

TITLE: SERIES IP-2550 ALUMINUM WINDOW WALL SYSTEM (WZ3) (IMPACT)

BILL OF MATERIALS AND COMPONENTS

PREPARED BY: BUILDING DROPS, INC.

1900 NE MIAMI COURT, STE. 2-15  
MIAMI, FL 33132  
PH: (954)399-8478  
FAX: (954)744-4738  
WEB: www.buildingdrops.com



REMARKS	BY	DATE

THE INSTALLATION DETAILS DESCRIBED HEREIN ARE GENERIC AND MAY NOT REFLECT ACTUAL CONDITIONS FOR A SPECIFIC SITE. IF SITE CONDITIONS CAUSE INSTALLATION TO DEVIATE FROM THE REQUIREMENTS DETAILED HEREIN, A LICENSED ENGINEER OR ARCHITECT SHALL PREPARE SITE SPECIFIC DOCUMENTS FOR USE WITH THIS DOCUMENT.

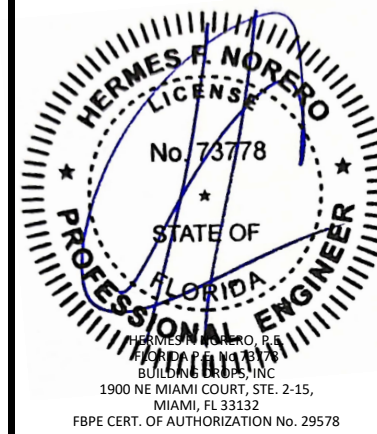

FL #:	<b>FL45921</b>
DATE:	<b>11.30.2023</b>
DWG. BY:	<b>SH</b>
CHK. BY:	<b>HN</b>
SCALE:	<b>NTS</b>
DWG. #:	<b>ARC013</b>
SHEET:	<b>8</b>